PFAFF[®] 241



Unterklassen-Ausstattung
Subclass parts
Composition des sous-classes
Composición de las subclases

Subclass organizations

Dotación de las subclases

Unterklasse Subclass Sous-classe Subclase	Ausführung Model Version Tipo de máquina	Nadelstange Needle bar Barre à aiguille Barra de aguja	Stoffschieber ⁴ Feed dog Griffe Transportador	Stichplatte ⁴ Needle plate Plaque à aiguille Placa de aguja	Nahfuß ⁴ Presser foot Pied presseur Pie prensatelas	Fingerschutz Finger guard Protège-déigts Salvadedos
-6/01	A; B; BN	91-009 678-91	91-040 347-04	91-040 348-04	91-040 349-03	91-046 864-25
-6/01-900/16;/56	A; B; BN	91-009 678-91	91-040 347-04	91-058 955-05	91-040 349-03	91-046 864-25
-55/01	B; BN	91-009 678-91	91-047 029-04	91-048 079-04	91-051 339-93	
-944/01	A; B; BN	91-009 678-91	91-026 672-04	91-040 032-04	91-051 255-93	91-009 492-91



⁴ = Ausführung angeben
= Indicate model
= Préciser la version

Unterklassen-Ubersicht / Table of subclasses / Table des sous-classes / Tabla de subclases

91-009 678-91

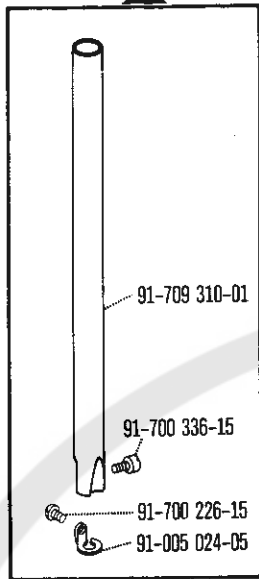

-6/01
-6/01-900/16;/56
-55/01
-944/01

91-026 672-04



-944/01

91-040 347-04



-6/01
-6/01-900/16;/56

91-047 029-04



-55/01

91-040 032-04



-944/01

91-040 348-04



-6/01

91-048 079-04



-55/01

91-058 955-05



-6/01-900/16;/56

91-040 349-03

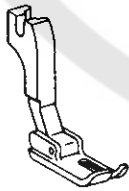

-6/01
-6/01-900/16;/56

91-051 255-93



-944/01

91-009 492-91

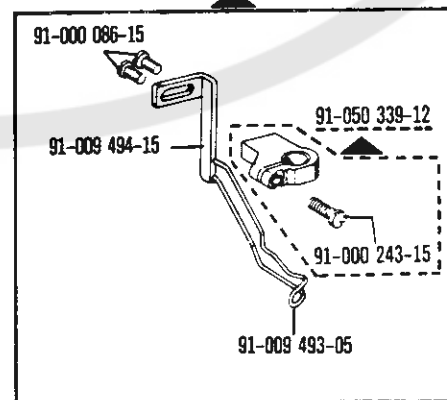

-944/01

91-051 339-93

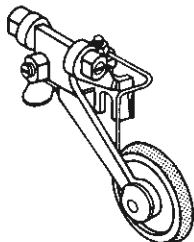

-55/01

91-046 864-25

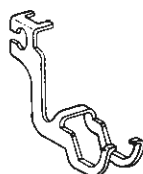

-6/01
-6/01-900/16;/56

PFAFF



**G.M. PFAFF
Aktiengesellschaft**

Postfach 3020
D-67653 Kaiserslautern

Königstr. 154
D-67655 Kaiserslautern

Telefon: (0631) 200-0
Telefax: (0631) 172 02
Telex: 45753 PFAFF D

Gedruckt in der BRD
Printed in Germany
Imprimé en R.F.A.
Impreso en la R.F.A.